



◆ Model number

GPY - 12 A 1 S 2 - L XXX

① ② ③ ④ ⑤ ⑥ ⑦ ⑧ ⑨

- | | | | |
|---|---|---|--|
| ① Series number
GPY series | ④ Position of ports
A : side ports | ⑥ Mounting
S : horizontal 4 bolts | ⑧ Rotation viewing from shaft end
L = counterclockwise
R = clockwise |
| ② Mounting spigot diameter
- : $\phi 50.774_{-0.05}$ | ⑤ Port configuration
1 : flange port
2 : G screw thread | ⑦ Shaft end
1 : JIS Spline
3 : Oldham | ⑨ Code number in 3 figures |
| ③ Size | | | |

◆ Specifications

Size	Displacement		Rated pressure			Speed min ⁻¹		Inlet pressure	Mass	
	cm ³	in ³	MPa	bar	psi	MIN.	MAX.		kg	lb
3	2.94	0.179	20.6	206	2987	700	3000	bar -0.20~0.30	1.2	2.64
4	4.05	0.247								
5.8	5.70	0.348								
7	6.99	0.426								
8	7.91	0.483	17.2	172	2494	500	MPa -0.02~0.03	1.4	3.08	
9	8.83	0.539								
10	9.93	0.606								
11.5	11.4	0.695	13.7	137	1987	2500	psi -2.9 ~4.35	1.4	3.08	
12	11.8	0.720								

◆ Typical assembly

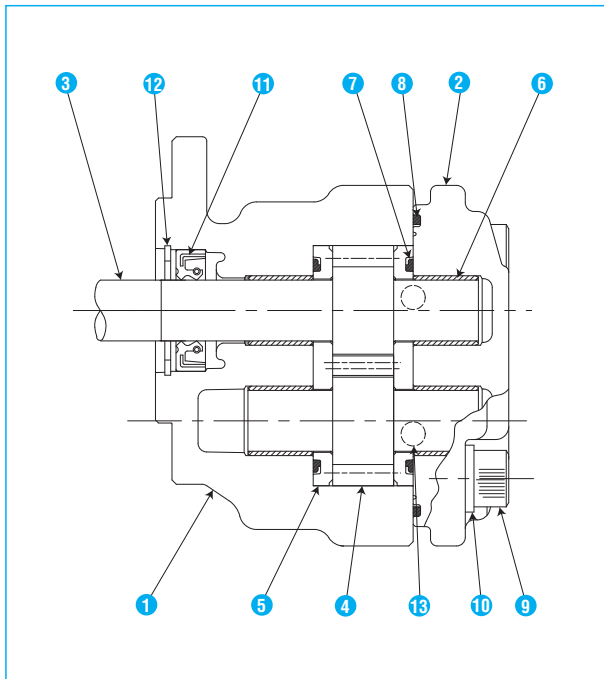

Item No.	Name	QTY	Material
①	Body	1	Aluminum alloy
②	Rear cover	1	Aluminum alloy
③	Drive gear	1	Alloy steel
④	Driven gear	1	Alloy steel
⑤	Side plate	2	Special alloy steel
⑥	Bush	4	Special alloy steel
⑦	Gasket	2	Nitrile rubber
⑧	Gasket	1	Nitrile rubber
⑨	Bolt	4	Alloy steel
⑩	Washer	4	Carbon steel
⑪	Oil seal	1	Nitrile rubber
⑫	Retainer ring	1	Carbon steel
⑬	Steel ball	2	Alloy steel

NOTES : "QTY" shows the amount per one

◆ Outline dimensions

dimensions in mm

GPY-□A1S□-LXXX (Flange ports)

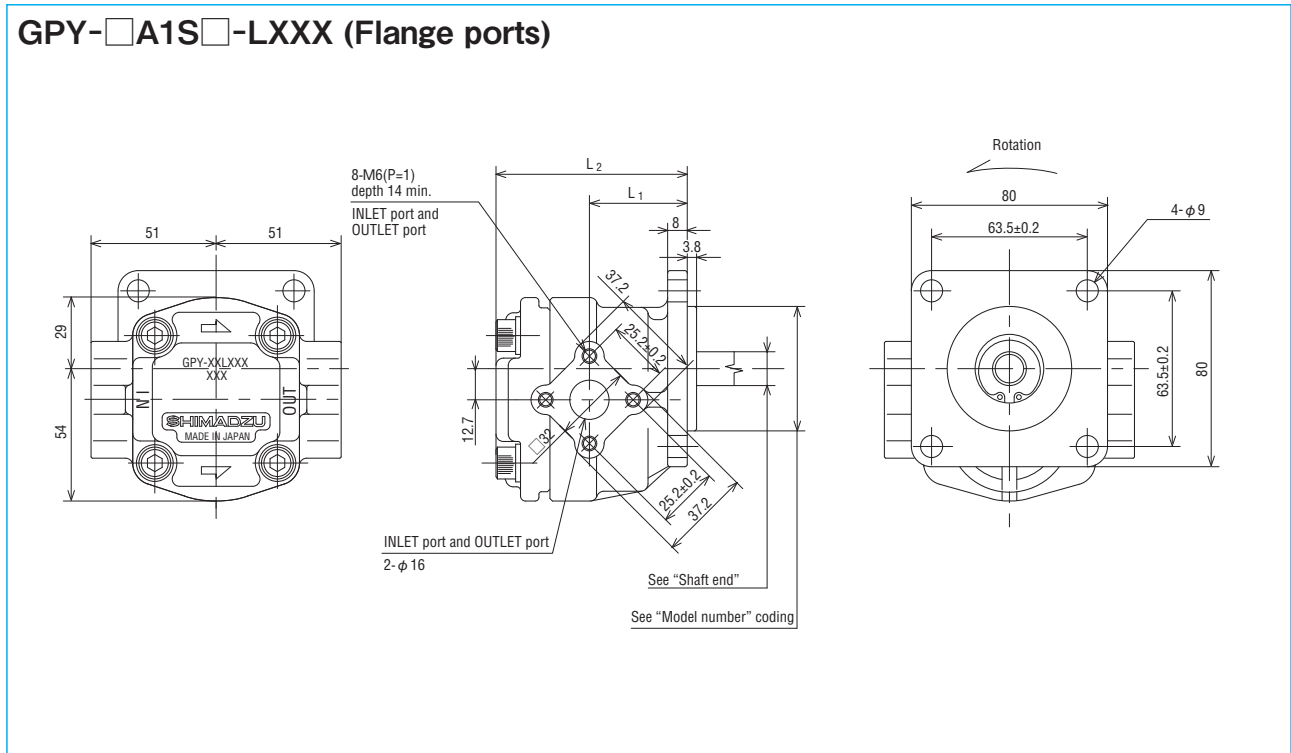

- NOTE 1. Figure shown indicated counterclockwise rotation "L" viewing from shaft end. Clockwise rotation "R" is mirror image of this.
2. Unless otherwise specified, tolerance on dimension are ± 1.0 mm.

Size	L ₁	L ₂
3	39.9	78
4		
5.8		
7		
8		
9	43.7	91
10		
11.5		
12		

● Shaft end

JIS Spline (14×12×1)

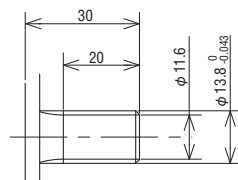

No. of tooth	: 12
Module	: 10
Pressure angle	: 20°
Over pin dia.	: 15.517~ 15.448
Pin dia.	: φ1.8